

RUNWAY DATA	EXISTING	ULTIMATE
RUNWAY LENGTH	3,400'	SAME
RUNWAY WIDTH	75'	SAME
PAVEMENT STRENGTH	22,000 LBS. SINGLE WHEEL	30,000 LBS. SINGLE WHEEL
APPROACH SURFACES	R/W 7: 20:1 NP (UTILITY) R/W 25: 20:1 NP (UTILITY)	SAME
RUNWAY MARKINGS	NON-PRECISION	SAME
RUNWAY LIGHTING	MIRL	SAME
RUNWAY NAVAIDS	R/W 7: PAPI-4R R/W 25: PAPI-4L, REILS	R/W 7: SAME R/W 25: SAME
EFFECTIVE GRADIENT	0.43%	SAME
RUNWAY END ELEVATIONS	R/W 7: 71.4' MSL R/W 25: 56.9' MSL	R/W 7: SAME R/W 25: SAME
RUNWAY END COORDINATES	R/W 7: 43° 57' 30" N 69° 43' 03" W R/W 25: 43° 57' 51" N 69° 42' 26" W	R/W 7: SAME R/W 25: SAME
RUNWAY SAFETY AREA	150' X 300'	SAME
RUNWAY OBJECT FREE ZONE	250' X 200'	SAME
RUNWAY OBJECT FREE AREA	500' X 300'	SAME
TAXIWAY LIGHTING	MILS	SAME
TAXIWAY MARKING	CENTERLINE, HOLDLINE	SAME
TAXIWAY OBJECT FREE AREA	131'	SAME

AIRPORT DATA	EXISTING	ULTIMATE
AIRPORT ELEVATION	71.4' MSL	SAME
AIRPORT REFERENCE POINT	LAT. 43° 57' 41" N LONG. 69° 42' 45" W	SAME
MEAN MAX. TEMP. (HOTTEST MO.)	78°F	SAME
DESIGN AIRCRAFT	BEECH KING AIR 90	SAME
FUEL AVAILABILITY	12,000 GALLONS	SAME
AIRPORT/TERMINAL NAVAIDS	AIRPORT BEACON, LIGHTED WIND CONE, WITH SEGMENTED CIRCLE, QFS, NDB	SAME
AIRPORT REFERENCE CODE (ARC)	B-II (UTILITY)	SAME

NOTE: BUILDING RESTRICTION LINE (BRL) WAS ESTABLISHED IN ACCORDANCE WITH FAA DESIGN AND FAR PART 77 CRITERIA. ITS LOCATION UTILIZES A 20 FT. VERTICAL OBJECT HEIGHT. THE BRL LOCATION MAY CHANGE DUE TO GROUND CONTOURS OR DIFFERENT OBJECT HEIGHTS, BUT ALWAYS IN ACCORDANCE WITH FAR PART 77 AND FAA DESIGN CRITERIA.

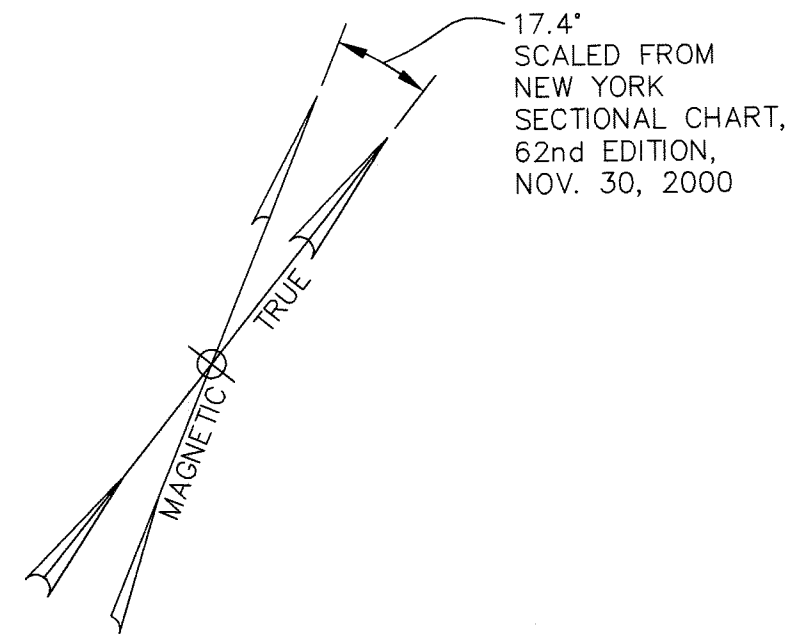

LEGEND	EXISTING	ULTIMATE
AIRPORT PROPERTY LINE	---	---
ABUTTERS' PROPERTY LINE	---	SAME
PAVEMENT	---	---
TREE LINE	---	---
AVIGATION EASEMENT LINE	---	SAME
FENCE LINE	---	SAME
BUILDINGS	---	SAME
UTILITY POLE	---	SAME
REIL	---	SAME
PAPI	---	SAME
LIGHTED WIND CONE	---	SAME
AIRPORT ROTATING BEACON	---	SAME
LIGHTED WIND CONE	---	SAME
SEGMENTED CIRCLE	---	SAME
OBJECT-FREE ZONE (OFZ)	---	SAME
OBJECT-FREE AREA (OFA)	---	SAME
RUNWAY SAFETY AREA (RSA)	---	SAME
BUILDING RESTRICTION LINE (BRL)	---	SAME
WETLANDS (DELINEATED)	---	SAME
WATER LINE EASEMENT	---	SAME

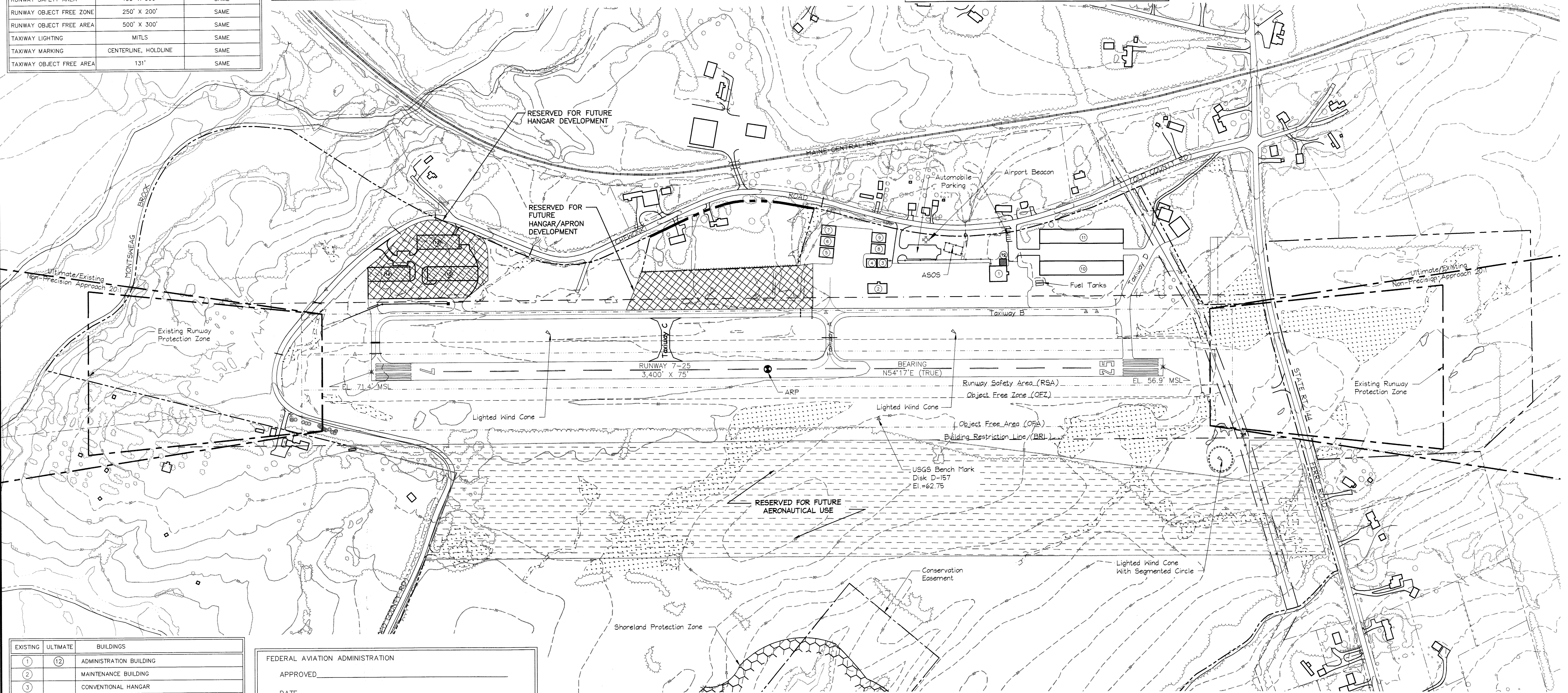
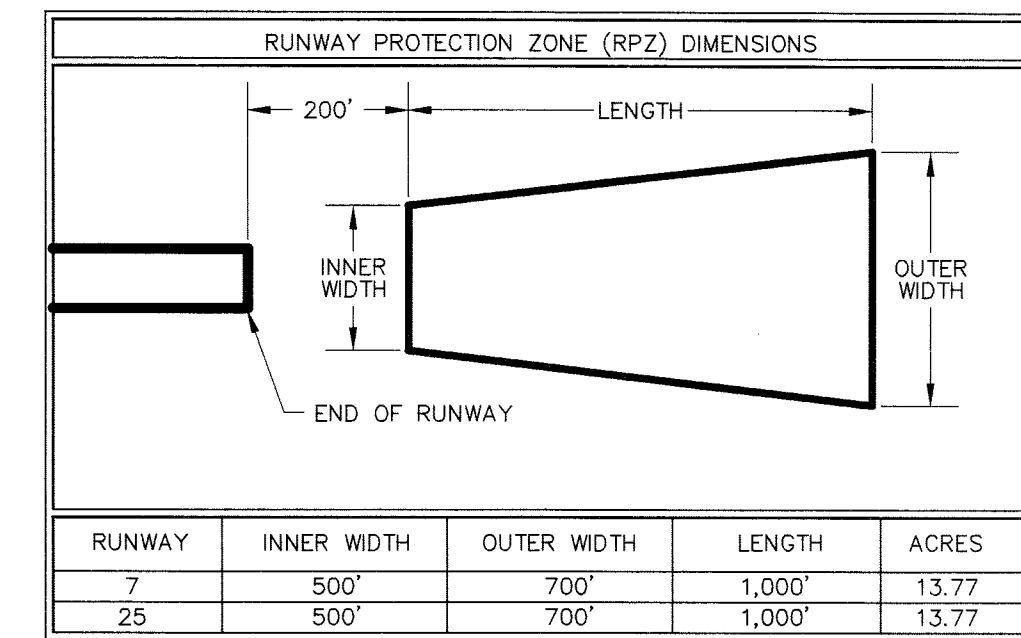

EXISTING	ULTIMATE	BUILDINGS
1	12	ADMINISTRATION BUILDING
2	2	MAINTENANCE BUILDING
3	3	CONVENTIONAL HANGAR
4	4	CONVENTIONAL HANGAR
5	5	CONVENTIONAL HANGAR
6	6	CONVENTIONAL HANGAR
7	7	CONVENTIONAL HANGAR
8	8	CONVENTIONAL HANGAR
9	9	CONVENTIONAL HANGAR
10	10	T-HANGAR
11	11	T-HANGAR
12	13	T-HANGAR
13	14	T-HANGAR
14	15	T-HANGAR

FEDERAL AVIATION ADMINISTRATION  
APPROVED \_\_\_\_\_  
DATE \_\_\_\_\_

MAINE DEPARTMENT OF TRANSPORTATION  
APPROVED \_\_\_\_\_  
DATE \_\_\_\_\_

TOWN OF WISCASSET  
APPROVED \_\_\_\_\_  
APPROVED \_\_\_\_\_  
APPROVED \_\_\_\_\_  
DATE \_\_\_\_\_

NONCONFORMING CONDITIONS				
DESCRIPTION	STANDARD	EXISTING/PLANNED	REMARKS	DATE APPROVED
NON-PRECISION APPROACH SURFACE ON RUNWAYS 7 AND 25	34:1	20:1/20:1	THIS 20:1 SLOPE IS USED BASED ON TERPS REQUIREMENTS	

CERTIFICATION:  
I HEREBY CERTIFY THAT ALL AIRPORT ELEMENTS SHOWN ON THIS ALP ARE IN ACCORDANCE WITH CRITERIA CONTAINED IN THE CURRENT EDITION OF FAA ADVISORY CIRCULAR 150/5300 13 EXCEPT AS NOTED IN THE TABLE.

NAME \_\_\_\_\_ DATE \_\_\_\_\_  
PRINTED NAME/TITLE \_\_\_\_\_

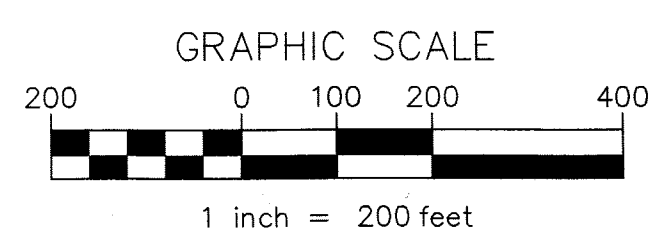

WISCASSET MUNICIPAL AIRPORT Chewonki Road Wiscasset, Maine			
ULTIMATE AIRPORT LAYOUT PLAN			
SCALE: AS NOTED	PROJECT NO. 715.07.01	DRAWING NO. MP-1	
DATE: October 18, 2007	SHEET 1 OF 1	Cod: 7150801_MP-1.dwg	
DES BY: JWC	APP BY: JWC	engineers architects surveyors construction managers	
DWN BY: JWC	CHK BY: JWC	343 Gorham Road · South Portland, ME 04106-2317 Tel: (207)761-1770 Fax: (207)774-1246 Web: www.oest.com Email: mail@oest.com	
REV. DESCRIPTION	DR. BY	LTP	MSD
B Replace/Relocate Airport Rotating Beacon	JWC	LTP	RDY 10-18-07
A Extension of Taxiway B	JWC	LTP	MSD 10-18-07